

Couplings



Description

Couplings for hydraulic or lubrication systems are required whenever a virtually leakage-free flow of media is to be separated or distributed. Typically, this happens e.g. when a pump is used to fill several lubricant reservoirs and must be connected and disconnected again and again.

For each coupling design/model, a corresponding hose is required. Conveniently, the coupling side is on the hose of the filling pump and the counterpart, the coupling nipple, is attached to the reservoir. Another coupling application in the field of lubrication systems is the coupling and uncoupling of groups of machines that need not be continuously supplied by one lubrication pump, e.g. for vehicle lubrication and trailer lubrication.

When selecting a coupling, the maximum possible pump/system pressure must be considered. In addition, there are couplings suitable mainly for either indoor or outdoor applications. If the application is not accurately defined before ordering, stainless steel or surface-treated couplings are the best choice. Couplings protect hydraulic fluids or lubricants for contamination and allow quick and high-pressure media flows.

Features and benefits

- Wide product range with different pressure rates and sizes
- Available for filling as well as for operation of automatic lubrication systems
- Quick couplings (ESK) for under-pressure coupling available
- Virtually leakage-free filling

Applications

- All kinds of lubrication systems
- Printing and packaging machines
- Construction and mining
- Metal forming machines
- Vehicles, trucks, loaders
- Agriculture machinery
- General industry
- Machine tools
- Etc.

Couplings

Low-pressure quick-disconnect couplings

Coupling, complete

Outer coupling member

Inner coupling member

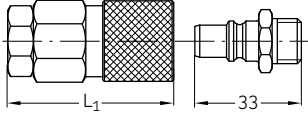
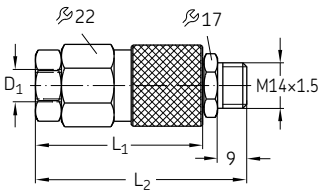

| Order number | Designation | Tube Ø D ₁ ¹⁾ | | L ₁ | L ₂ | Material | Operating pressure max. | | Weight | |
|--------------|-----------------------|-------------------------------------|---------|----------------|----------------|-------------------|-------------------------|-----|--------|------|
| | | mm | mm | | | | bar | psi | g | lb |
| 207-168-2 | COUPLING, COMPLETE | 6 | M10×1 | – | 65 | Steel, galvanized | 45 | 653 | 150 | 0.33 |
| 207-188-2 | COUPLING, COMPLETE | 8 | M14×1,5 | – | 71,5 | Steel, galvanized | 45 | 653 | 152 | 0.34 |
| 207-168.U7 | OUTER COUPLING MEMBER | 6 | – | 51,5 | – | Steel, galvanized | 45 | 653 | 120 | 0.26 |
| 207-188.U11 | OUTER COUPLING MEMBER | 8 | – | 58 | – | Steel, galvanized | 45 | 653 | 130 | 0.29 |
| 207-168.U2 | INNER COUPLING MEMBER | – | – | – | – | Steel, galvanized | 45 | 653 | 22 | 0.05 |

Both coupling members are shut off when disconnected!

¹⁾ Ports tapped for solderless tube connection

Medium- and high-pressure quick-disconnect couplings

995-001-525, 995-001-526

626-26246-1

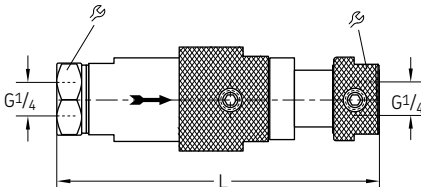
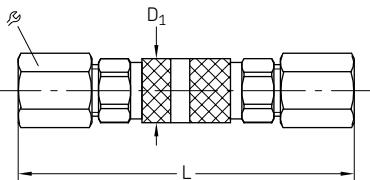

| Order number | Designation | Tube Ø D ₁ | | L | Ø | Material | Operating pressure max. | | Weight | |
|--------------|----------------------------------|-----------------------|----|-----|----|-------------------|-------------------------|-------|--------|------|
| | | mm | mm | | | | bar | psi | g | lb |
| 995-001-525 | PLUG AND SOCKET COUPLING, TUBE 4 | 4 | 10 | 68 | 10 | Steel, galvanized | 100 | 1 450 | 30 | 0.07 |
| 995-001-526 | PLUG AND SOCKET COUPLING, TUBE 6 | 6 | 15 | 80 | 12 | Steel, galvanized | 100 | 1 450 | 35 | 0.08 |
| 626-26246-1 | COUPLING ESK G1/4 D | – | – | 124 | 27 | Steel, galvanized | 300 | 4 351 | 760 | 1.68 |

Couplings

Coupling plugs

995-001-096

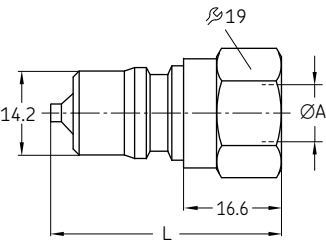

995-001-501

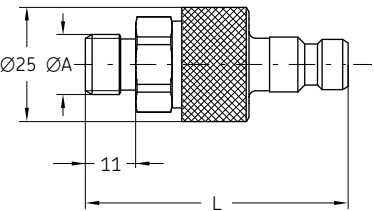

995-000-705

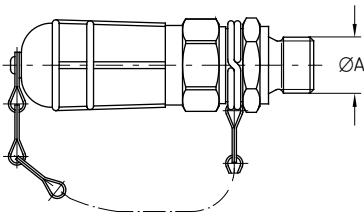

995-001-260

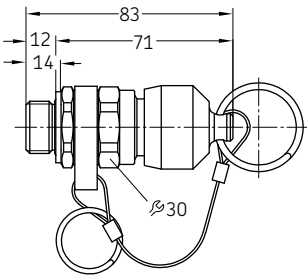

995-001-950

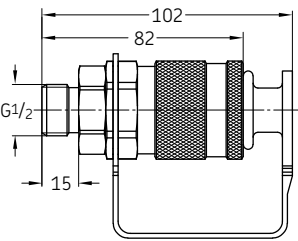

995-001-500

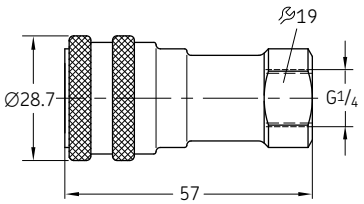

| Order number | Designation | Material | ØA | L | Respective dust cover Order number | Respective coupling socket Order number | Operating pressure max. | | Weight | |
|--------------|---------------------------|-------------------|-------|------|------------------------------------|---|-------------------------|-------|---------------------|--------------------|
| | | | mm | mm | | | bar | psi | g | lb |
| 995-001-096 | COUPLING PLUG G1/4 350BAR | Steel, galvanized | G 1/4 | 39 | 995-001-235 | – | 350 | 5 080 | 60 ¹⁾ | 0.13 ¹⁾ |
| 995-001-501 | COUPLING PLUG G1/4 200BAR | Steel, galvanized | G 1/4 | 57.5 | 995-001-503 | 995-002-073 | 200 | 2 900 | 305 ²⁾ | 0.67 ²⁾ |
| 995-001-502 | COUPLING PLUG G1/2 250BAR | Steel, galvanized | G 1/2 | 82 | 995-001-504 | 995-001-950 | 250 | 3 600 | 1 050 ²⁾ | 2.32 ²⁾ |
| 995-000-705 | COUPLING PLUG G1/4 70BAR | Steel, galvanized | G 1/4 | – | – | 995-001-500 | 70 | 1 000 | 233 ³⁾ | 0.51 ³⁾ |
| 995-001-260 | COUPLING PLUG G1/2 | Steel, galvanized | G 1/2 | 83 | – | – | – | – | 229 | 0.50 |

¹⁾ weight for plug + dust cover

²⁾ weight for complete coupling

³⁾ weight for plug + coupling socket

Couplings

Coupling sockets with return flow port

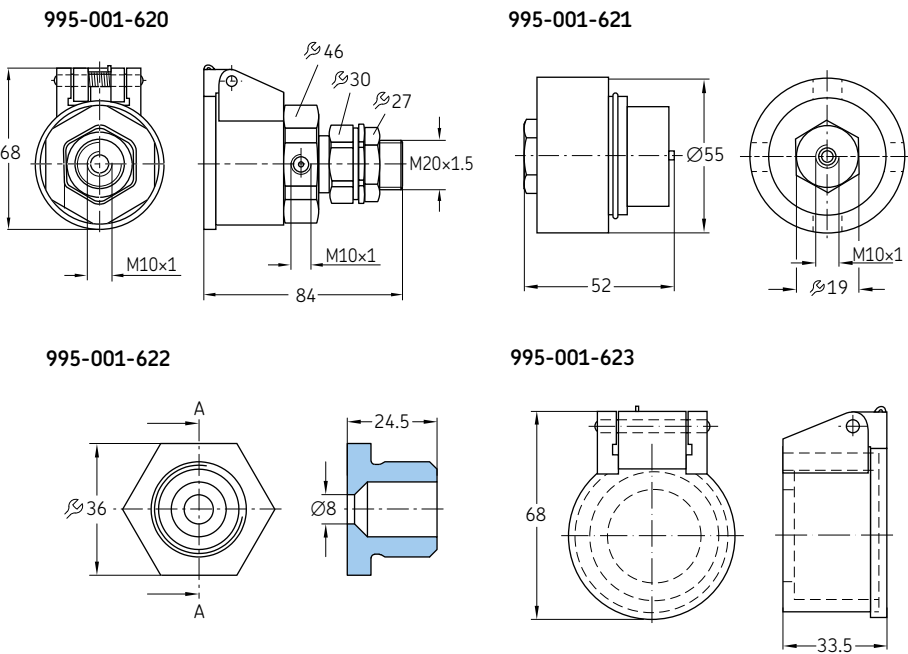

| Order number | Designation | Material | Operating pressure max. | | Weight | |
|--------------|-----------------|-------------------|-------------------------|-------|--------|------|
| | | | bar | psi | g | lb |
| 995-001-620 | COUPLING SOCKET | Steel, galvanized | 100 | 1 450 | 480 | 1.06 |
| 995-001-621 | COUPLING PLUG | Steel, galvanized | 100 | 1 450 | 380 | 0.84 |
| 995-001-622 | STUB | Steel, galvanized | 100 | 1 450 | 100 | 0.22 |
| 995-001-623 | DUST COVER | Steel, galvanized | 100 | 1 450 | 55 | 0.12 |